

CANBERRA CONTEMPORARY ART SPACE

44 Queen Elizabeth Terrace
Parkes ACT 2612 Australia
www.ccas.com.au
info@ccas.com.au
+61 2 6247 0188
ABN 87 390 438 711

CCAS MANUKA APPLICATIONS

Name:

Address:

Phone Number:

Email:

Website / Social Media:

ABN:

GST Registered: Y / N

In the spirit of reconciliation Canberra Contemporary Art Space acknowledges the Traditional Custodians of Country throughout Australia and their connections to land, sea and community. We pay our respect to their Elders past, present and emerging, and extend that respect to all Aboriginal and Torres Strait Islander peoples on whose lands we live and work.

ABOUT YOU

How old are you?

- | | | | |
|---------|--------------------------|---------|--------------------------|
| 18 – 25 | <input type="checkbox"/> | 26 – 40 | <input type="checkbox"/> |
| 41 – 60 | <input type="checkbox"/> | 60+ | <input type="checkbox"/> |

Do you identify as Aboriginal and / or Torres Strait Islander?

- | | | | |
|------------------------|--------------------------|---------|--------------------------|
| Aboriginal | <input type="checkbox"/> | Both | <input type="checkbox"/> |
| Torres Strait Islander | <input type="checkbox"/> | Neither | <input type="checkbox"/> |

Do you identify as Culturally and Linguistically Diverse?

- | | | |
|-----|--------------------------|--|
| Yes | <input type="checkbox"/> | If you would like to, please describe: |
| No | <input type="checkbox"/> | |

How would you describe your gender identity? (Select all that apply)

- | | | | |
|----------------|--------------------------|------------|--------------------------|
| Female | <input type="checkbox"/> | Non-Binary | <input type="checkbox"/> |
| Male | <input type="checkbox"/> | Trans | <input type="checkbox"/> |
| Gender-Neutral | <input type="checkbox"/> | Other | <input type="checkbox"/> |

If you would like to, please describe:

Do you identify as living with a disability?

- | | | |
|----------------|--------------------------|--|
| Yes | <input type="checkbox"/> | If you would like to, please describe: |
| No | <input type="checkbox"/> | |
| Rather Not Say | <input type="checkbox"/> | |

As an artist, do you identify as:

- | | |
|-------------|--------------------------|
| Emerging | <input type="checkbox"/> |
| Mid-Career | <input type="checkbox"/> |
| Established | <input type="checkbox"/> |

CCAS MANUKA PROPOSAL GUIDELINES

Proposal

Please provide information of your proposed exhibition, including:

- A two-sentence summary
- A 250-word description of the conceptual intent
- If you are proposing a group exhibition, please nominate who will be curating the exhibition and the artists involved
- Approximate number of works, size and medium

Support Material

Please provide the following:

- CV (1 page per artist)
- Please provide 5 - 10 high quality .jpeg images of the proposed work (2mb per image max). All images must be labelled with artist, title of work, year, medium, dimensions and photo credit (e.g. Jane Smith, Bliss, 2022, oil on canvas, 80 x 120 cm, photo by John Smith). Please also indicate whether the images are actual work to be exhibited or indicative work.

Send Applications to

Alexander Boynes

Curator and Program Manager

alexander@ccas.com.au or 02 6247 0188

CCAS MANUKA FLOORPLAN

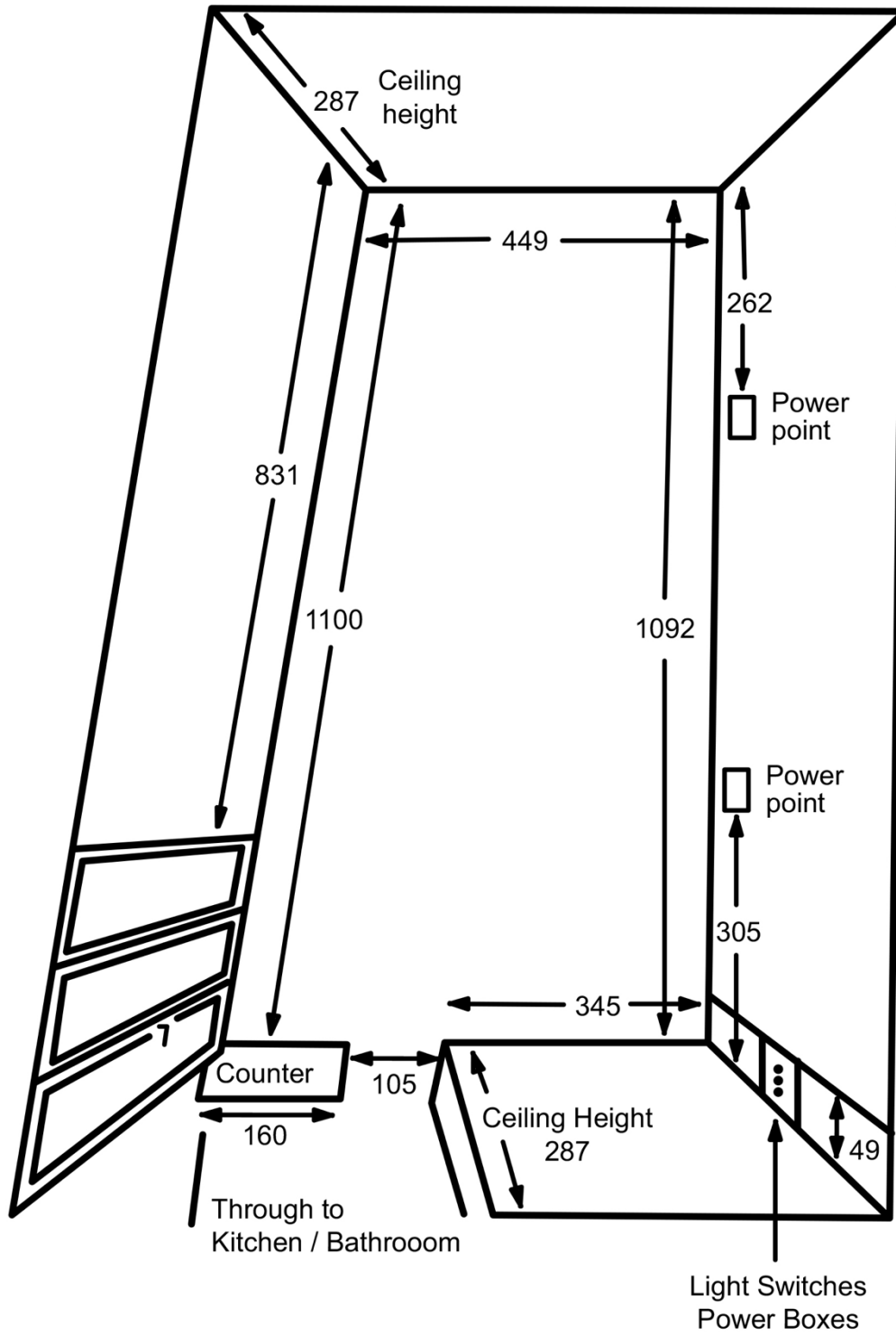

CCAS MANUKA EXHIBITION APPLICATION FAQs

What is Canberra Contemporary Art Space?

Since its establishment in 1981 Canberra Contemporary Art Space (CCAS) has become one of Australia's leading spaces for the creation and presentation of contemporary art. Working with artists both inside and outside of the ACT across a range of disciplines, CCAS provides opportunities for artists to create and show new, ambitious and daring work. CCAS is a space for collaboration, consultation and conversation and an opportunity for emerging and established practitioners to experiment and exhibit.

CCAS is a member of the Contemporary Arts Organisations Australia, that are seen as centres of innovation, new ideas and directions for the contemporary visual arts. The CCAS program of exhibitions, performances, artists' talks, public programs and publications generates an environment in which artists can produce work of the highest quality in the context of current national and international practice. CCAS exhibitions and related public programs run over two spaces at Canberra Contemporary Art Space in Parkes and Manuka.

We are supported by the National Capital Authority and the ACT Government for our gallery program.

How long do exhibitions last?

We have 12 exhibition slots available from July to December, each lasting two weeks.

What is the gallery hire fee for 2024?

CCAS Manuka rental is \$925 (GST inclusive) for two weeks.

What does that cover?

Our fees cover the hire of the space for two weeks, media release editing and distribution, social media, and website and email promotion.

Paying Your Deposit and / or Gallery Hire Fee

You can pay your deposit and /or Gallery Hire Fee via direct bank transfer, or in person at CCAS (Parkes location). If paying by direct bank transfer, please put in the description "CCAS Manuka Rental – [your last name]. Our Bank Details are below:

Bank Australia
Canberra Contemporary
BSB 313140
Account Number 12433794

About the Gallery

CCAS Manuka has track lighting, tea and coffee making facilities, paint and some installation tools are provided, toilet facilities, heater and fan, and a front desk. This space is ideal for experimental work and small group shows.

What is the exhibitor responsible for?

Artist/s are responsible for the installation and de-installation/packing of their exhibition (including sold works) and the repair of walls where needed. The artist is also responsible for sitting the gallery during advertised opening hours and recording audience numbers. Sales are the responsibility of the artist/s, there is currently no commission on sales.

How big is the Gallery?

There are four gallery walls providing approximately 27 linear metres of available wall space. The gallery is approximately 6m x 11m, with 2.9m ceiling height. *Please refer to the Gallery Floor plan for specific measurements.*

What is the exhibition selection process?

Applications are assessed by the Program Manager, in conjunction with the Director. Selections are made on the merit demonstrated by the quality of the application, and in consideration of the balance of our whole program. Preference is given to artists who have a strong record of involvement in Canberra's visual arts community and on the excellence of the work.

How will I know if my application has been successful?

All applicants, whether successful or unsuccessful, will be notified of the result of their application within one month after the round closing via email. Once the application round has closed, all successful applicants will be notified and provided with an online link to nominate their preferred exhibition time. In order for this process to be as fair as possible, this link will be provided to all successful applicants at the same time, and selection of exhibition times will be 'first in, best dressed'.

COVID-19-Safety Policy

Due to COVID-19 safety precautions, the following must be adhered to during your Manuka exhibition time slot. *Please refer to our COVID-19 Safety Plan for more detailed information.*

- Artists are to use the CCAS COVID-19 Safety Plan
- Practice physical distancing of 1.5m between visitors
- Hand sanitiser and cleaning materials will be provided
- No public use of the bathroom
- Outside rubbish bins to be used by visitors

Do I need Public Liability Insurance?

Yes. You can get this easily by becoming a [NAVA Member](#).

Sitting the Gallery

The Gallery is open to the public Friday to Sunday, 11am – 5pm. The artist/s can open the gallery outside of these advertised opening hours at their prerogative, in consultation with CCAS. The artist/s will be responsible for invigilating the Gallery during any extra opening hours.

Serving Alcohol

If you are hosting events such as opening / closing functions, workshops or artist talks and serving alcohol **you must** have a current Responsible Service of Alcohol (RSA) Certificate, or someone with a current RSA must be present for these events.

Contract

Successful applicants will be provided with an Artist Contract, which includes a Checklist with all exhibition responsibilities and deadlines.